

Client: Customer Ref.: Date: / / Delivery desired date: / /

01. INSTALLATION AREA

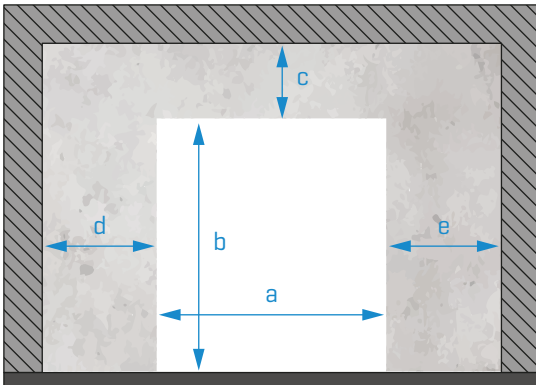

Quantity

Local dimensions [mm]:

MANDATORY FILLING

a

b

c

d

e

PVC color:

<input type="checkbox"/> 5013	<input type="checkbox"/> 5002	<input type="checkbox"/> 5015
<input type="checkbox"/> 6026	<input type="checkbox"/> 3002	<input type="checkbox"/> 2004
<input type="checkbox"/> 1003	<input type="checkbox"/> 1015	<input type="checkbox"/> 9005
<input type="checkbox"/> 7037	<input type="checkbox"/> 7038	<input type="checkbox"/> 7035
<input type="checkbox"/> 9016	<input type="checkbox"/> 5010	<input type="checkbox"/> 7016

Other:

Additional devices:

MPR020

Tunnel kit

UPS [Price on request]

Remote control

Radars

Magnetic loop

Model

All doors are lacquered in RAL9010 Textured

If you want another colour or finish, please mention here:

STAINLESS STEEL 304

STAINLESS STEEL 316

Without transparent strip

Mark if you **do not want** transparent strip

Other Options:

OBSERVATIONS:

IN THIS SPACE YOU SHOULD DESCRIBE EVERYTHING YOU FIND RELEVANT TO THE AUTOMATISM PRODUCTION

MOTOR AND CONTROL BOARD POSITION:

Motor installed on the left

Motor installed on the right

Control Board installed on the left

Control Board installed on the right

IN THIS SPACE YOU SHOULD DRAW EVERYTHING YOU FIND RELEVANT TO THE AUTOMATISM PRODUCTION

02. TECHNICAL DRAWING (NORMAL KIT)

Dimensions in mm

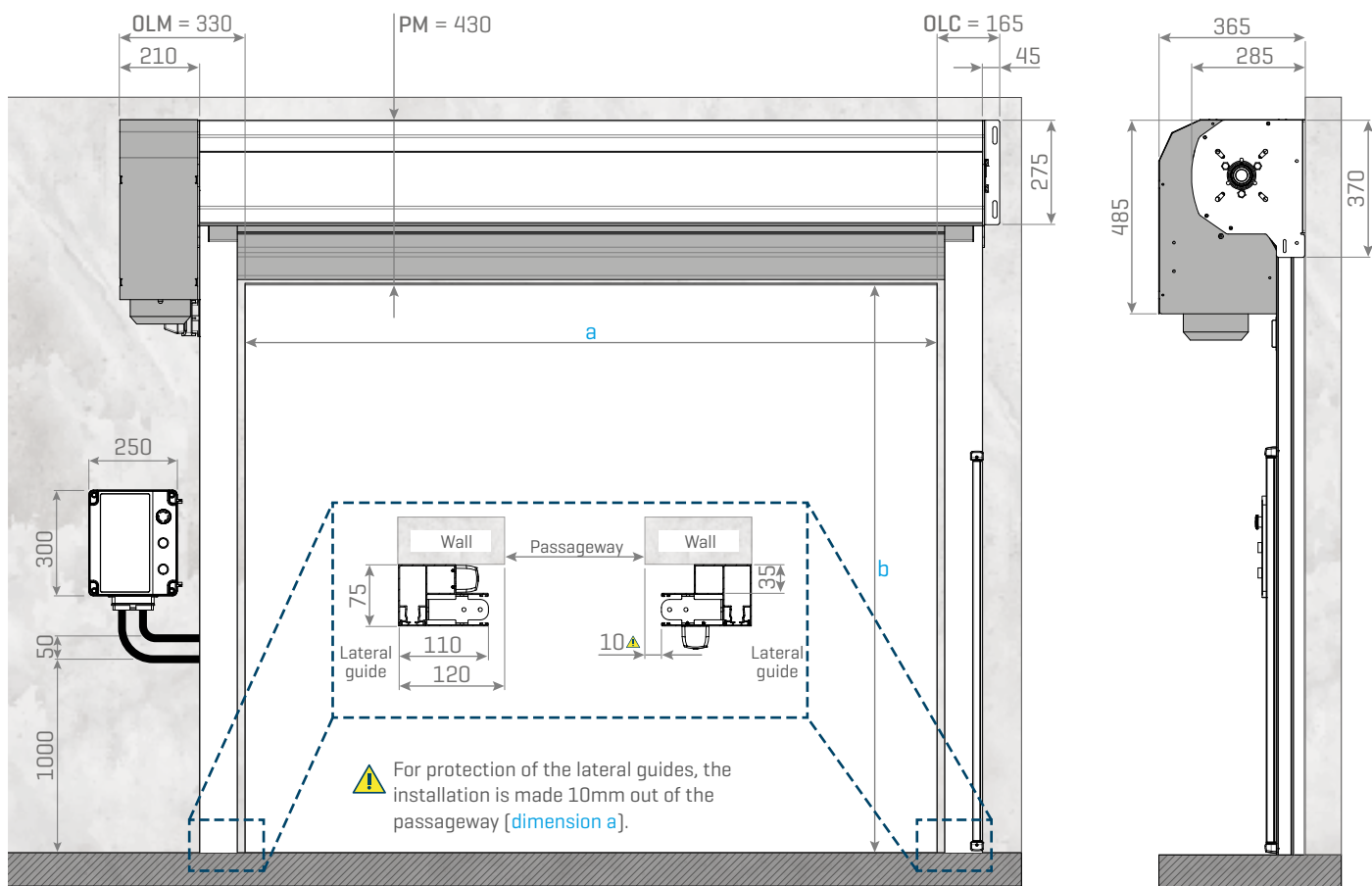

Legenda: OLM - Motors side clearance; OLC - Opposite side clearance; PM - Minimum Lintel

02. TECHNICAL DRAWING (TUNNEL KIT)

Dimensions in mm

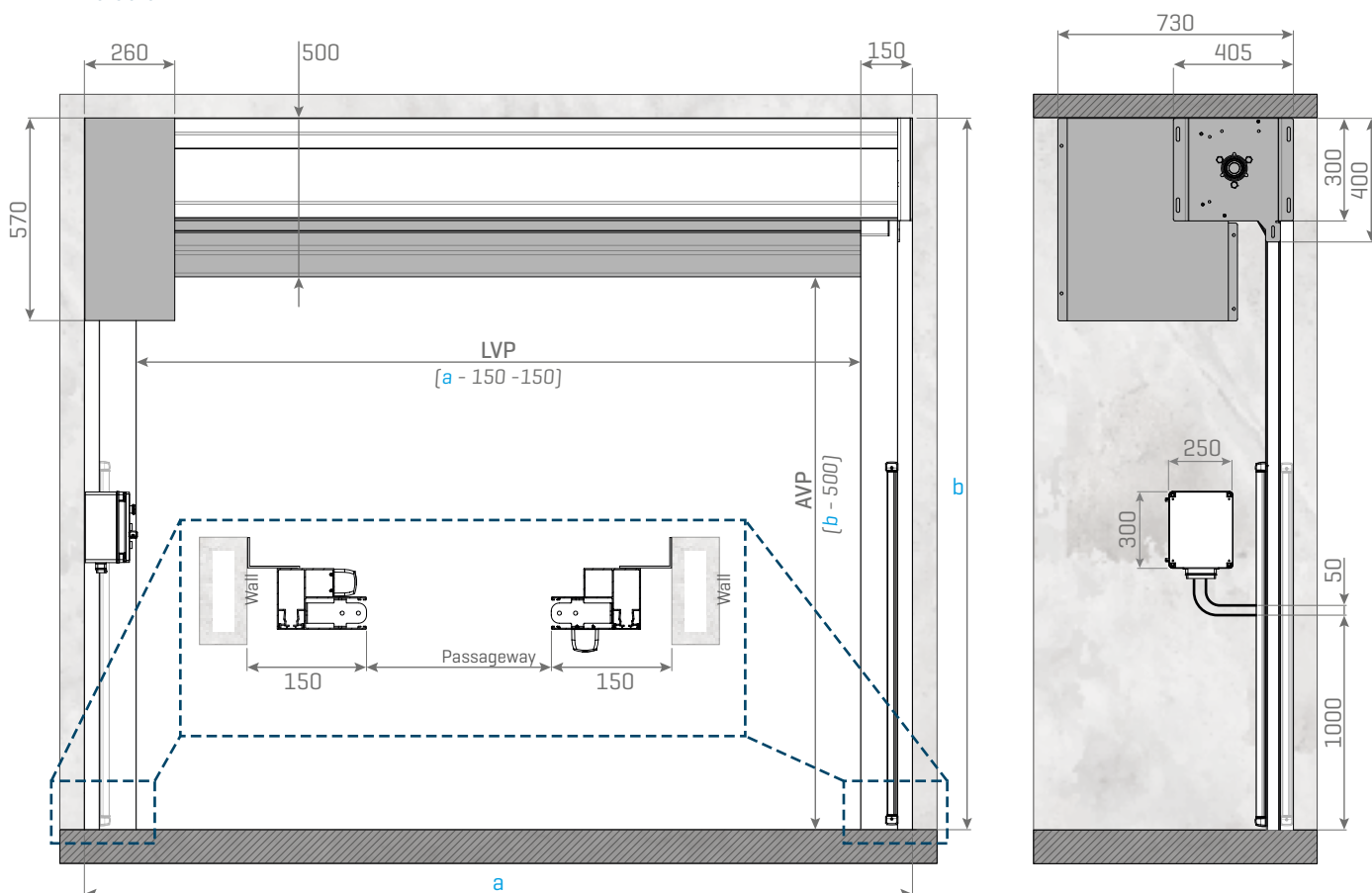

Legenda: LVP - Width of passageway; AVP - Height of passageway;