

M CELE 01 Selector | USER'S AND INSTALLER'S MANUAL

TECHNICAL SPECIFICATIONS

The "M CELE 01" selector has 5 operating modes: Total Opening, Total Closing, Partial Opening, Exit Only and Automatic Mode. These modes can be operated with or without a security password. This switch contains a LED (light effect) and a buzzer (sound effect) to assist the programming procedure. It is powered by 15VDC directly from the door's automatism. It contains memory in case of power failure.

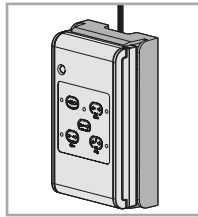

• SELECTOR DESCRIPTION

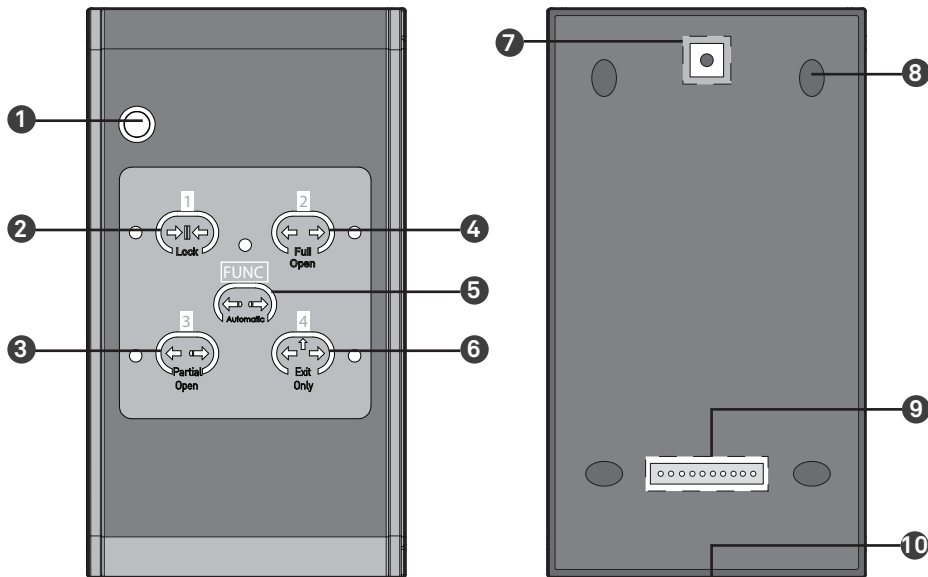

1	LED	6	Exit Only
2	Always Closed	7	RESET Button
3	Partial Opening (Automatic Functioning)	8	Wall fixation
4	Always Open	9	Connector
5	Total Opening (Automatic Functioning)	10	Box screw

CONNECTIONS DIAGRAM

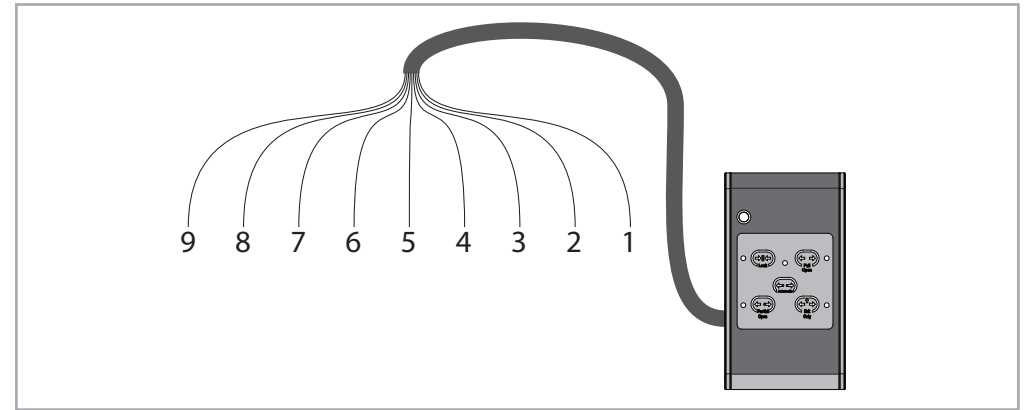

№	WIRE COLOR	INPUT	DESCRIPTION
1	Grey	PED	Partial opening contact
2	Brown	PED	Partial opening contact
3	Orange	COM	Opening dry contact
4	Purple	PUL	Opening dry contact
5	Blue	SIG	Electric lock signal
6	Green	RIN	Internal sensor signal
7	White	REX	External sensor signal
*	Yellow	ACCESS	Not used
8	Black	GND	(GND)
9	Red	15V	12V~36V DC Power Supply

RECEIVER INSTALLATION

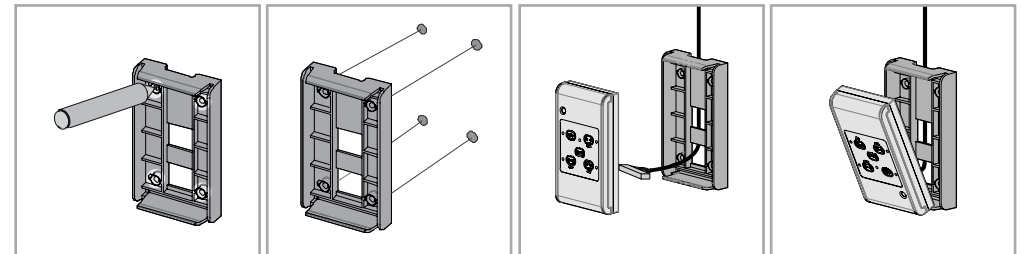

01. Mark the holder mounting points and drill the holes.
02. Point the holder and insert the dowels and screws.
03. Pass the wire and fit the connector on the support.
04. Place the selector on the support. Leave the cable stretched.

SELECTOR PROGRAMMING

• FUNCTIONS



Always Closed

• All radars and controllers are disabled. The lock is automatically triggered, which causes the door to close. If you connect a fire alarm and put the door in this function, the door will not open if it receives an alarm order.



Always Open

• All radars and controllers are disabled. The door stays open.



Partial Opening (Automatic Operation)

• The radars are activated. The door opens only partially (65% of total course) automatically. Whenever activated this function, the door does a new path recognition.



Exit Only

• The external radar is disabled and the lock is activated automatically. The controllers and inner radar stay activated. Only opens for exiting people.



Total Opening (Automatic Operation)

• All radars and controllers are activated. The door opens and closes automatically.

• PROGRAMMING

You can use the selector in two modes: Code and Free. In "code" it is necessary to put a combination of four numbers (original code is 1234) to change the operating function.

Changing from "Code Mode" to "Free Mode":

Press and hold the FUNC button + 1 key (LOCK) for 5 sec. The selector will beep and the light changes from red (Code mode) to green, indicating that it is in free mode. Repeat the procedure to switch to code mode.

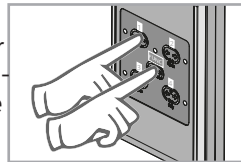

Change the selector's function in "Code Mode":

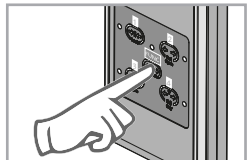

01 • Press and hold the FUNC button for 5 sec. The selector will beep and the LED turns green.

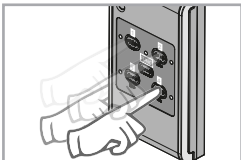

02 • Enter the code (original - 1234).

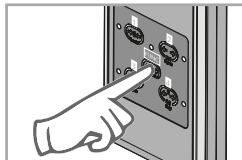

03 • Press the FUNC button to confirm.

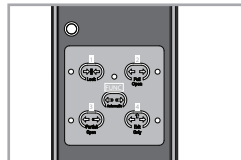

04 • Choose one of the functions described above by pressing the key corresponding to the function.

SELECTOR PROGRAMMING

Change the selector's function in "Free Mode":

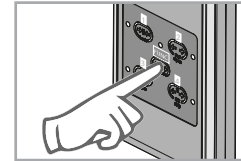

In "free" mode, you can select the desired function by pressing it for 5sec, without having to put the password.

Change Password:

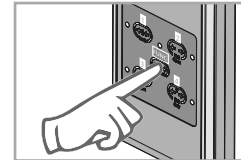

01 • Press and hold the FUNC button for 10 sec. The selector will beep twice. First at 5 sec and then at 10 sec.

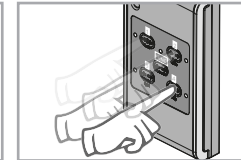

02 • Enter the code (original - 1234).

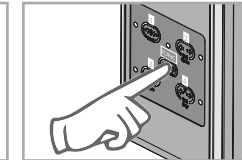

03 • Press the FUNC button to confirm.

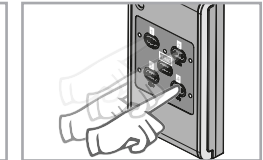

04 • Enter a new code.

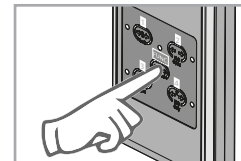

05 • Press the FUNC button to confirm.

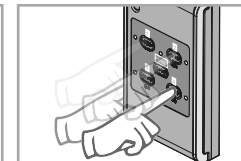

06 • Enter for a second time the new code.

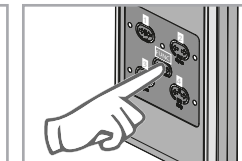

07 • Press the FUNC button to confirm again. The new password is now set.

Reset the Selector:

In case of forgetting your password, follow the next steps:

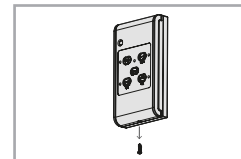

01 • Unscrew the screw cover (below the switch) and remove the rear panel.

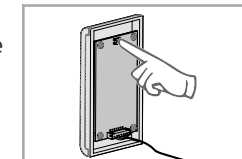

02 • With the selector on, press the RESET button on the board for 40sec.

03 • The selector beeps once confirming the reset's success. The password returns to 1234. Refit the back cover and tighten the screw.