

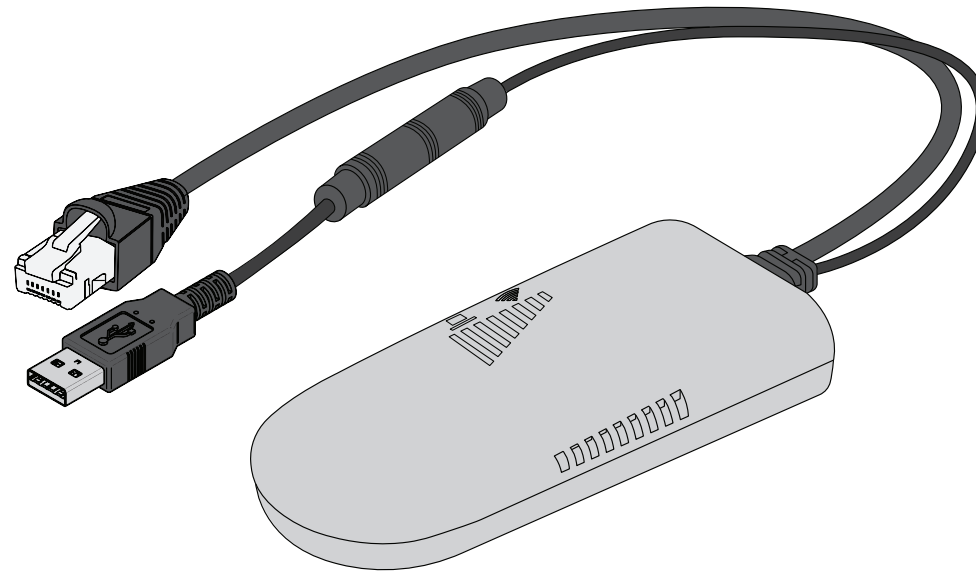

# MPX-WIFI

## USER AND INSTALLER MANUAL







# 00. CONTENT

## INDEX

<b>01. SAFETY INSTRUCTIONS</b>	<b>1B</b>
<b>02. THE PRODUCT</b>	
PRODUCT DESCRIPTION	4A
TECHNICAL CHARACTERISTICS	4A
DIMENSIONS	4A
APPLICATION MODES	4B
<b>03. CONFIGURATION</b>	
CONNECT THE DEVICE	5B
CONFIGURE THE APPLICATION	6A
LED SIGNALING	7A
RESET	7B
<b>04. TROUBLESHOOTING</b>	
INSTRUCTIONS FOR FINAL CONSUMERS / SPECIALIZED TECHNICIANS	8

# 01. SAFETY INSTRUCTIONS

## ATTENTION:

	This product is certified in accordance with European Community (EC) safety standards.
<b>RoHS</b>	This product complies with Directive 2011/65/EU of the European Parliament and of the Council, of 8 June 2011, on the restriction of the use of certain hazardous substances in electrical and electronic equipment and with Delegated Directive (EU) 2015/863 from Commission.
	(Applicable in countries with recycling systems). This marking on the product or literature indicates that the product and electronic accessories (eg. Charger, USB cable, electronic material, controls, etc.) should not be disposed of as other household waste at the end of its useful life. To avoid possible harm to the environment or human health resulting from the uncontrolled disposal of waste, separate these items from other types of waste and recycle them responsibly to promote the sustainable reuse of material resources. Home users should contact the dealer where they purchased this product or the National Environment Agency for details on where and how they can take these items for environmentally safe recycling. Business users should contact their vendor and check the terms and conditions of the purchase agreement. This product and its electronic accessories should not be mixed with other commercial waste.
	
	This marking indicates that the product and electronic accessories (eg. charger, USB cable, electronic material, controls, etc.) are susceptible to electric shock by direct or indirect contact with electricity. Be cautious when handling the product and observe all safety procedures in this manual.

# 01. SAFETY INSTRUCTIONS

## **GENERAL WARNINGS**

- This manual contains very important safety and usage information. very important. Read all instructions carefully before beginning the installation/usage procedures and keep this manual in a safe place that it can be consulted whenever necessary.
- This product is intended for use only as described in this manual. Any other enforcement or operation that is not mentioned is expressly prohibited, as it may damage the product and put people at risk causing serious injuries.
- This manual is intended firstly for specialized technicians, and does not invalidate the user's responsibility to read the "User Norms" section in order to ensure the correct functioning of the product.
- The installation and repair of this product may be done by qualified and specialized technicians, to assure every procedure are carried out in accordance with applicable rules and norms. Nonprofessional and inexperienced users are expressly prohibited of taking any action, unless explicitly requested by specialized technicians to do so.
- Installations must be frequently inspected for unbalance and the wear signals of the cables, springs, hinges, wheels, supports and other mechanical assembly parts.
- Do not use the product if it is necessary repair or adjustment is required.
- When performing maintenance, cleaning and replacement of parts, the product must be disconnected from power supply. Also including any operation that requires opening the product cover.
- The use, cleaning and maintenance of this product may be carried out by any persons aged eight years old and over and persons whose physical, sensorial or mental capacities are lower, or by persons without any knowledge of the product, provided that these are supervision and instructions given by persons with

- experienced in terms of usage of the product in a safe manner and who understands the risks and dangers involved.
- Children shouldn't play with the product or opening devices to avoid the motorized door or gate from being triggered involuntarily.

## **WARNINGS FOR TECHNICIANS**

- Before beginning the installation procedures, make sure that you have all the devices and materials necessary to complete the installation of the product.
- You should note your Protection Index (IP) and operating temperature to ensure that is suitable for the installation site.
- Provide the manual of the product to the user and let them know how to handle it in an emergency.
- If the automatism is installed on a gate with a pedestrian door, a door locking mechanism must be installed while the gate is in motion.
- Do not install the product "upside down" or supported by elements do not support its weight. If necessary, add brackets at strategic points to ensure the safety of the automatism.
- Do not install the product in explosive site.
- Safety devices must protect the possible crushing, cutting, transport and danger areas of the motorized door or gate.
- Verify that the elements to be automated (gates, door, windows, blinds, etc.) are in perfect function, aligned and level. Also verify if the necessary mechanical stops are in the appropriate places.
- The central must be installed on a safe place of any fluid (rain, moisture, etc.), dust and pests.
- You must route the various electrical cables through protective tubes, to protect them against mechanical exertions, essentially on the power supply cable. Please note that all the cables must enter the central from the bottom.
- If the automatism is to be installed at a height of more than 2,5m

# 01. SAFETY INSTRUCTIONS

from the ground or other level of access, the minimum safety and health requirements for the use of work equipment workers at the work of Directive 2009/104/CE of European Parliament and of the Council of 16 September 2009.

- Attach the permanent label for the manual release as close as possible to the release mechanism.
- Disconnect means, such as a switch or circuit breaker on the electrical panel, must be provided on the product's fixed power supply leads in accordance with the installation rules.
- If the product to be installed requires power supply of 230Vac or 110Vac, ensure that connection is to an electrical panel with ground connection.
- The product is only powered by low voltage safety with central (only at 24V motors)

## WARNINGS FOR USERS

- Keep this manual in a safe place to be consulted whenever necessary.
- If the product has contact with fluids without being prepared, it must immediately disconnect from the power supply to avoid short circuits, and consult a specialized technician.
- Ensure that technician has provided you the product manual and informed you how to handle the product in an emergency.
- If the system requires any repair or modification, unlock the automatism, turn off the power and do not use it until all safety conditions have been met.
- In the event of tripping of circuits breakers or fuse failure, locate the malfunction and solve it before resetting the circuit breaker or replacing the fuse. If the malfunction is not repairable by consult this manual, contact a technician.
- Keep the operation area of the motorized gate free while the gate is in motion, and do not create strength to the gate movement.

Do not perform any operation on mechanical elements or hinges if the product is in motion.

## RESPONSABILITY

- Supplier disclaims any liability if:
  - Product failure or deformation result from improper installation use or maintenance!
  - Safety norms are not followed in the installation, use and maintenance of the product.
  - Instructions in this manual are not followed.
  - Damaged is caused by unauthorized modifications
  - In these cases, the warranty is voided.

### **MOTORLINE ELECTROCELOS SA.**

Travessa do Sobreiro, nº29  
4755-474 Rio Côvo (Santa Eugénia)  
Barcelos, Portugal

## SYMBOLS LEGEND:



• Important safety notices



• Useful information



• Programming information



• Potentiometer information



• Connectors information



• Buttons information

## 02. THE PRODUCT

### PRODUCT DESCRIPTION

MPX-WIFI is intended to facilitate the installation of any access control or product that requires a network cable.

It transforms all equipment that needs a network cable (RJ-45) into WiFi, being able to connect the equipment to an existing network.

### TECHNICAL CHARACTERISTICS

Transmission Distance	
• Point-to-point transmission distance (in open field)	250 to 300 m
• Transmission speed	300 Mbps
• Frequency	2,4 Ghz

Power supply	
• Power Supply	5V 1A
• Voltage	5 to 15 Vdc
• Input power	≥ 5W

### DIMENSIONS

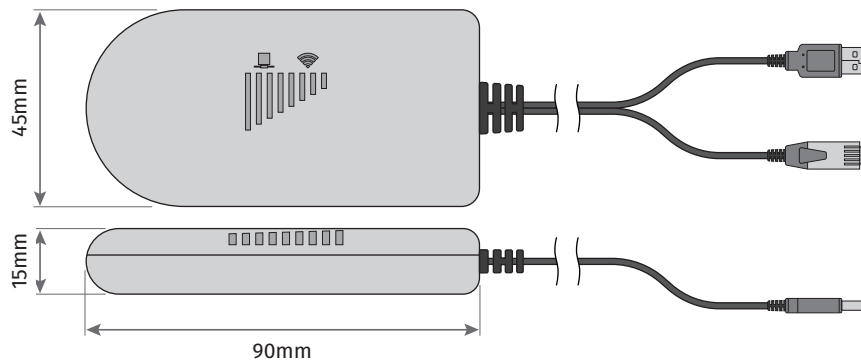

## 02. THE PRODUCT

### APPLICATION MODES

#### • WIFI REPEATER

MPX-WIFI devices are used to extend the wireless signal coverage of the existing Access Point or Router.

The computer can connect to the device without using the network cable (via WiFi).

**If you connect MPX-WIFI to an Access Point, the DHCP server is automatically disabled.**

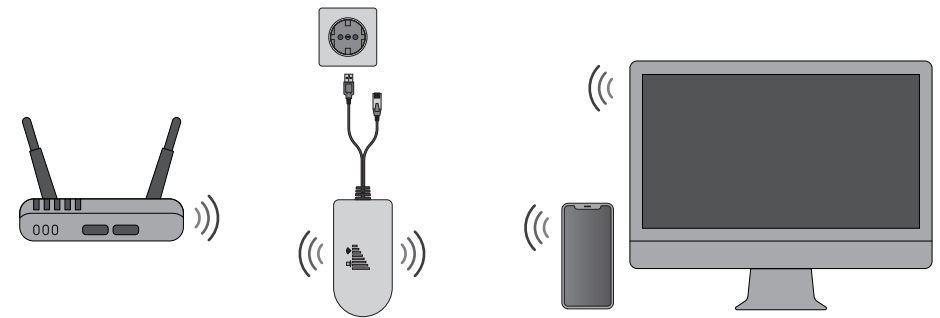

#### • WIFI BRIDGE

MPX-WIFI devices are used to extend the wireless signal coverage of the existing Access Point or Router.

The computer can connect to the device via the network cable.

**If you connect MPX-WIFI to an Access Point, the DHCP server is automatically disabled.**

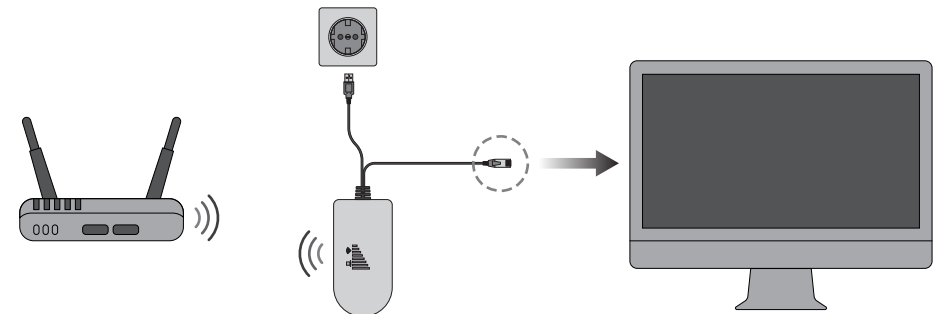

## 02. THE PRODUCT

### APPLICATION MODES

#### • WIFI ACCESS POINT

The MPX-WIFI device allows to distribute wireless signal from a LAN point to network cables. The computer can connect to the device without using the network cable (via WiFi).

**If you connect MPX-WIFI to the LAN point, the DHCP server is automatically disabled.**

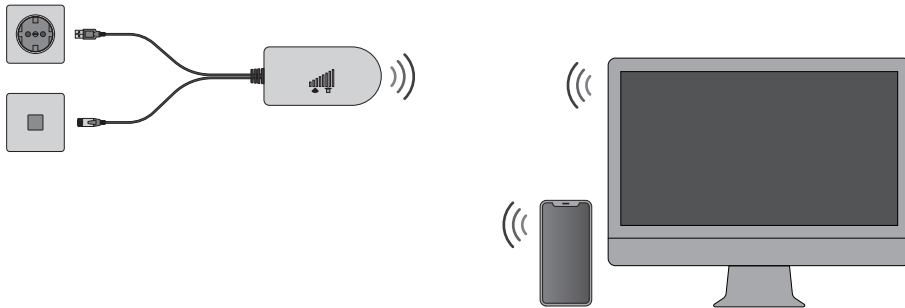

## 03. CONFIGURATION

### CONNECT THE DEVICE

**01** • Connect the device to power (5V/2A) and then connect it to the computer. There are two ways to connect MPX-WIFI with computer:

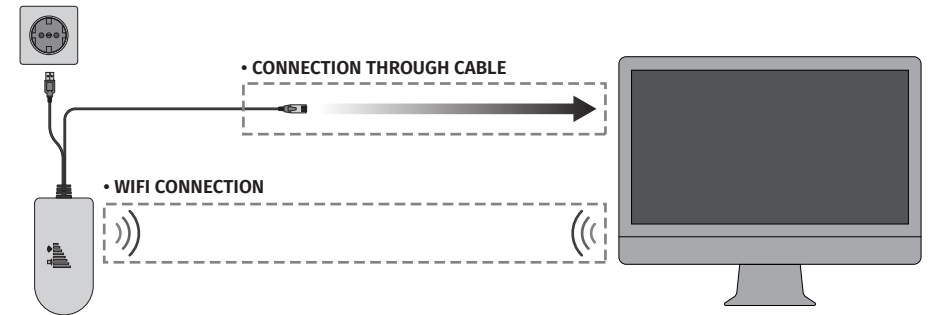

#### • CONNECTION THROUGH CABLE

The **MPX-WIFI** device is connected via cable with the LAN input of the computer.

#### • WIFI CONNECTION

The connection between the **MPX-WIFI** device and the computer is via WiFi signal.

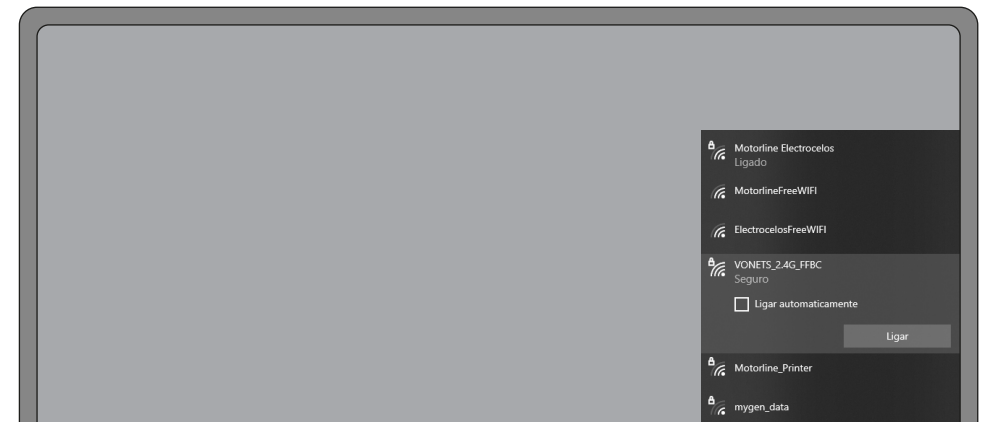

**02** • For **WIFI CONNECTION**, open the computer's network list and connect to the device by entering the access parameters.



The access parameters for **WIFI CONNECTION** are:

- **SSDI WiFi:** VONETS\_\*\*\*\*\* (corresponds to the MAC address of the MPX-WIFI device)
- **Password:** 12345678

# 03. CONFIGURATION

## CONFIGURE THE APPLICATION

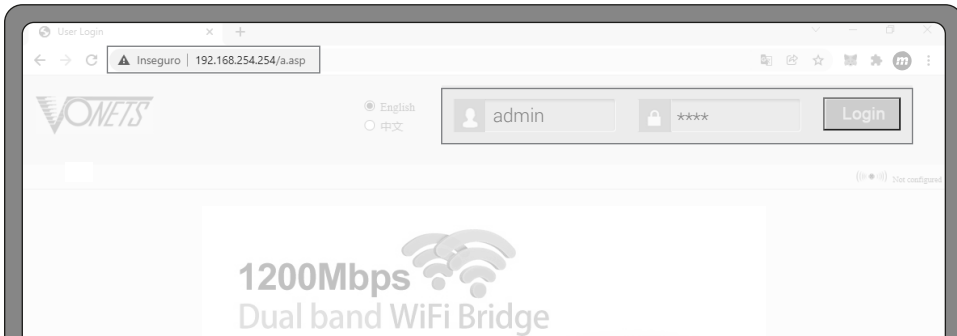

- 01 • Open the browser and enter the access IP to open the configuration page.
- Access IP: 192.168.254.254
- 02 • Log in to the page by typing the username and password.



The access parameters are:

- Username: admin
- Password: admin

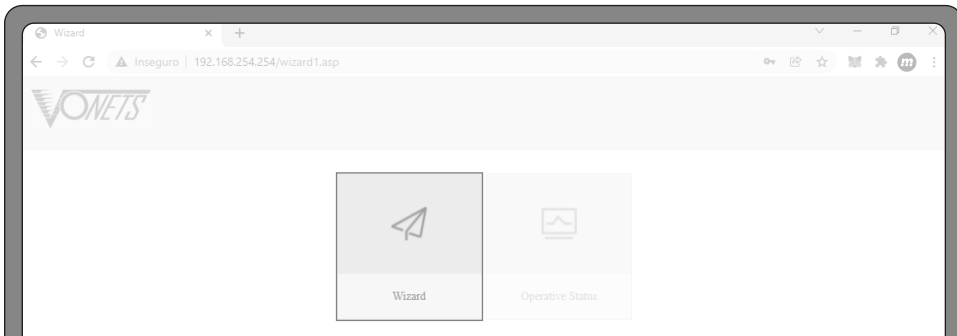

- 03 • Click [Wizard] option to proceed to configuration.

# 03. CONFIGURATION

## CONFIGURE THE APPLICATION

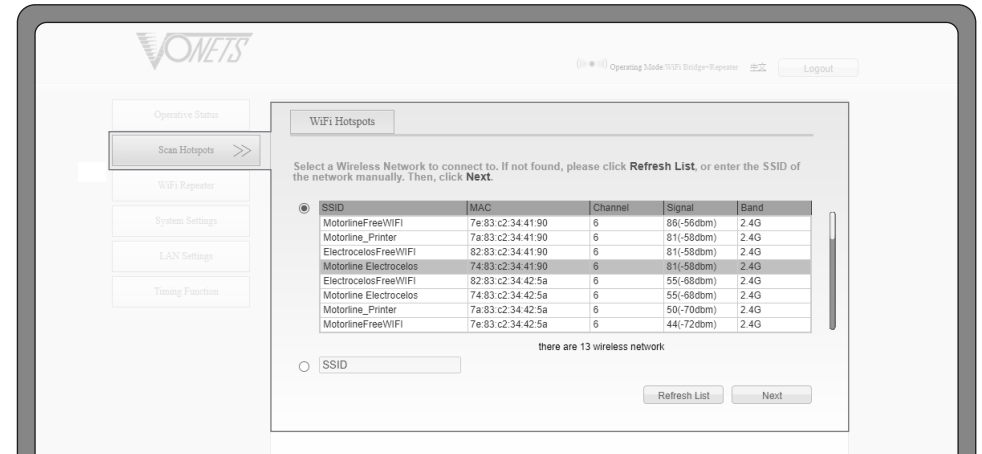

- 04 • Open the **Scan Hotspots** tab, and in the **WiFi Hotspots** tab, select the Hotspot corresponding to your network and click [Next].

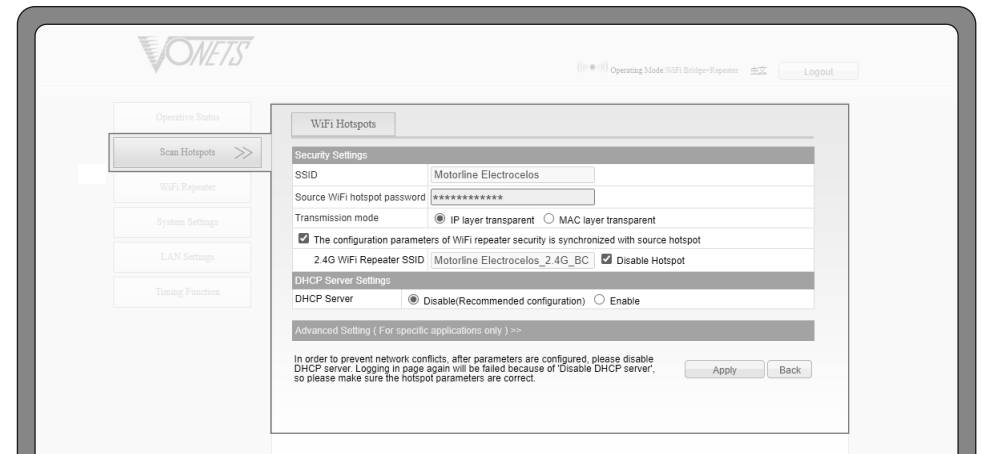

- 05 • In the network configuration window, activate the field (Disable Hotspot) and click [Apply] to confirm the changes.



If you want to use MPX-WIFI as a repeater, keep the (Disable Hotspot) field off.

## 03. CONFIGURATION

### CONFIGURE THE APPLICATION

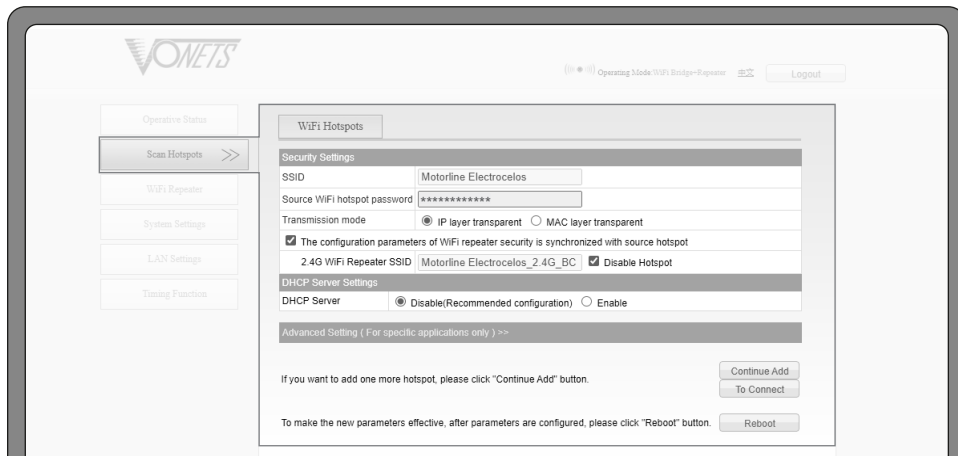

06 • Then click **[Reboot]** for the MPX-WIFI to restart and connect directly to the configured WiFi Access Point.

*The WiFi LED will flash quickly confirming successful connection.*

### LED SIGNALING

The following table indicates the device status depending on the displayed colours.

LED Signaling		
	WiFi (Blue Light)	Internet Cable (Green Light)
• No connection to an Access Point	Flashes slowly	-
• Successfully connecting to an Access Point	Flashes quickly	Flashes quickly
• Connection to a Access Point with failures	Flashes slowly	Flashes slowly

## 03. CONFIGURATION

### RESET

01 • Turn on the device and wait 60 seconds.

02 • Then press the Reset button for 5 seconds.

The green light will flash for a few seconds and the device will automatically reset to factory settings (this process takes approximately 60 seconds).



During factory reset, the product cannot be turned off, otherwise it may cause damage to the product.



## 04. TROUBLESHOOTING

### INSTRUCTIONS FOR FINAL CONSUMERS / SPECIALIZED TECHNICIANS

Anomaly	Causes	Procedure
<ul style="list-style-type: none"> <li>The device's WiFi access point is discoverable but it is impossible to connect the computer or smartphone.</li> </ul>	The device has taken an unexpected action or been turned off, causing the programmed data to be lost.	Reset the device to factory settings.
	The device does not work on the strongest channel or performs poorly.	Try changing the source WiFi access point and device channel to improve performance.
	Incorrect login data was entered on the smartphone or computer.	Re-enter the device login data on your computer or smartphone.
<ul style="list-style-type: none"> <li>The device has been configured with the parameters of the source WiFi access point, the smartphone or computer has been connected to the device WiFi hotspot, but there is no Internet.</li> </ul> <p><b>Check the LED signaling table (page 7A) to see what the current status of the device is, before proceeding to possible causes.</b></p>	The distance between the device and the source WiFi access point is too long, causing degradation on the communication performance and affecting the user's access to the Internet.	Reduces the distance between the source WiFi access point and the device.
	The device has taken an unexpected action or been turned off, causing the programmed data to be lost.	Reset the device to factory settings.
	The device does not work on the strongest channel or performs poorly.	Try changing the source WiFi access point to be the same as the channel set on the device.
	There are multiple WiFi access points close to the device causing WiFi channel interference and worsening performance.	Try changing the source WiFi access point and device channel to improve performance.
	Source WiFi access pint parameters are not correct.	Enter the correct parameters and restart the device.
<ul style="list-style-type: none"> <li>The smartphone or computer has been connected to the device by WiFi or Ethernet cable, but the user cannot log in to the device's web page, or after logging in to the web, there is an error.</li> </ul>	User is not using a browser recommended for MPX-WIFI (IE, Google Chrome, Safari, smartphone browser).	Use a browser compatible with the device.
	The smartphone or computer has activated the firewall, raising the level of security.	Shut down the firewall.
	The browser's security level is high.	Lower your browser's security level and sign in again.
	The device's input IP address is wrong.	For a new factory device, the user just needs to enter the correct IP address as shown in the instruction manual.